

UNITED STATES BUREAU OF ENTOMOLOGY AND PLANT INDUSTRY  
 DEPARTMENT OF AGRICULTURE  
 WASHINGTON, D. C. 20250

By H. Thomas L. Cutler and George S. Blaha, Jr.  
 (N. E. 100-100)

CONTENTS

Field Service KVMA (M...)  
 P. Manag... Area (Og...)

TABLES OF FIELD DATA

- 1. KVMA April 2 - May 10
- 2. KVMA May 16 - July 5
- 3. KVMA
- 4. General

GENERAL FIELDING TABLES

- 5. KVMA
- 6. KVMA
- 7. KVMA
- 8. General

DETAILS OF FIELD CONTENTS

- 9. KV Nest, Eggs and Young (No. CB Control)
- 10. KV Nest and Eggs, with CB Control
- 11. KV Young
- 12. KV Nest and Eggs ( " " " )
- 13. KV Young ( " " " )

GENERAL TABLES OF SUMMARIES OF KV NESTS

- 14. 956
- 15. 957
- 16. 958

GENERAL TABLES OF SPECIES OTHER THAN KV AT OSEMAN

- 17. 956
- 18. 957 and 1968

SUMMARY OF CB CONTROL AND KV PARASITISM 1963-1971

# U.S. FOREST SERVICE KIRTLAND'S WARBLER MANAGEMENT AREA

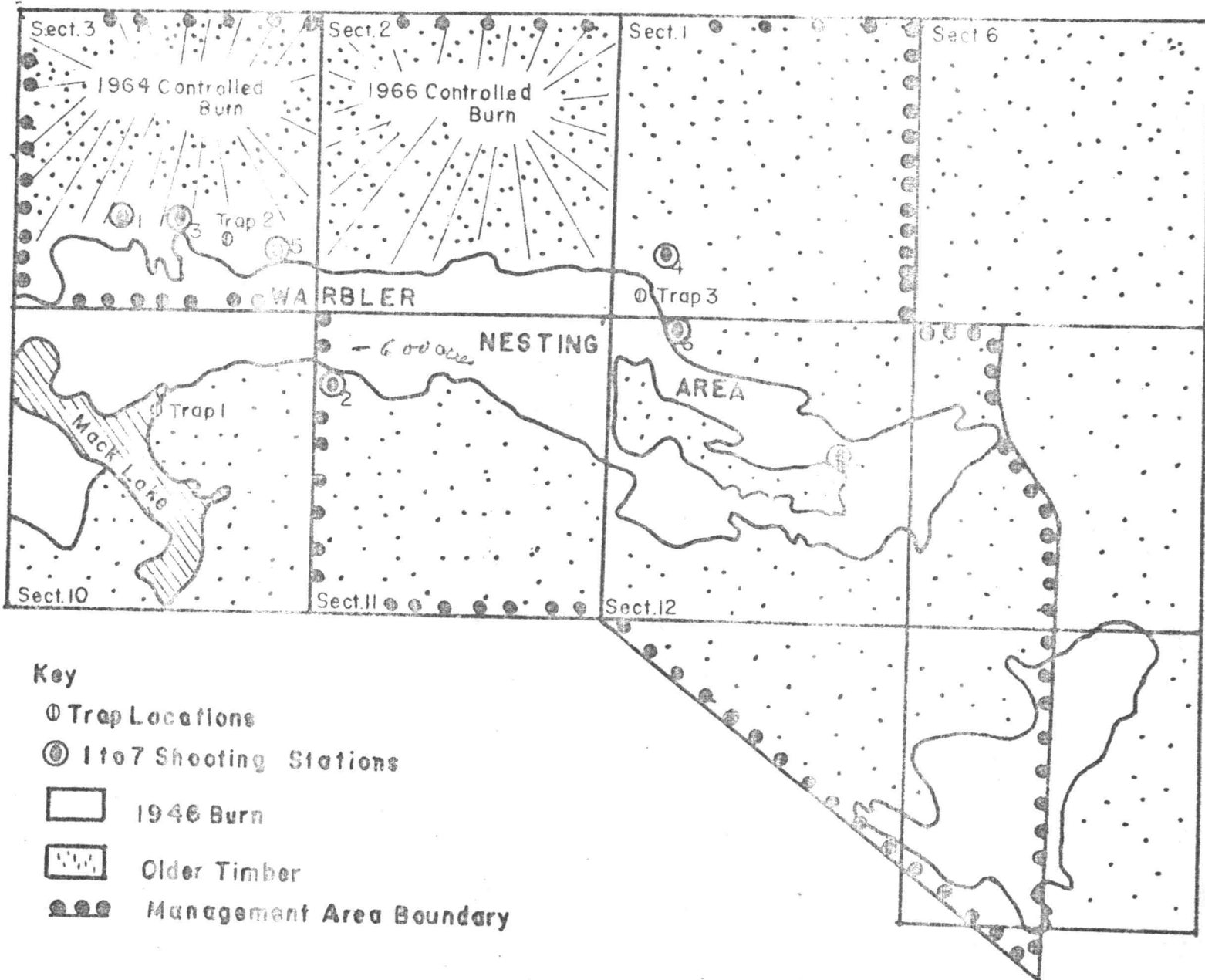
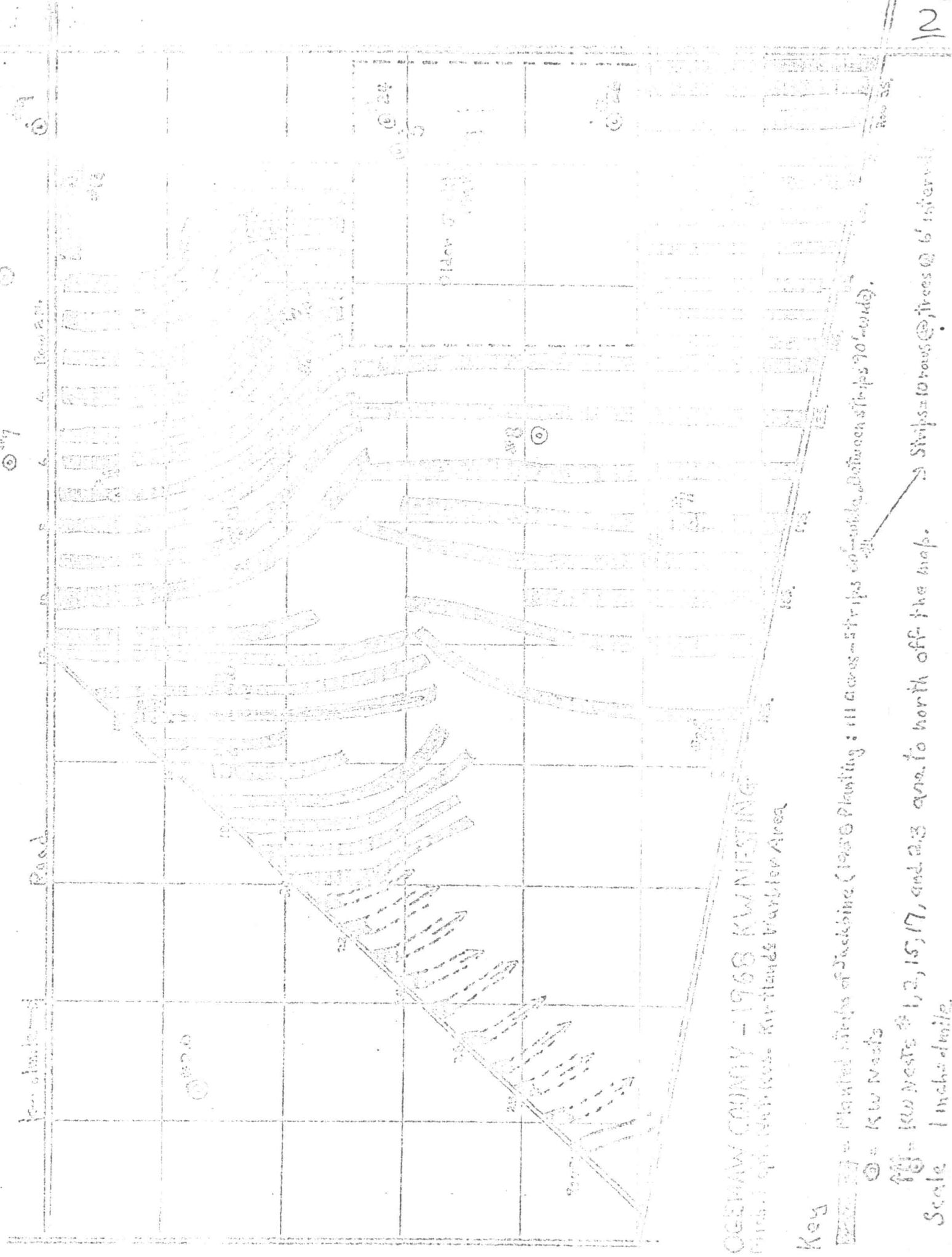

FIGURE 7



OGDEN COUNTY - 1968 K.W. NESTING  
 1968 1 sp. (K.W. Nests - K.W. Nests) Marble Area

Key

▨ = Planted strips of Japanese Knotweed (1968) Planting: 11 acres - strips 60' wide. Between strips 70' wide.

○ = K.W. Nests

① = K.W. Nests # 1, 2, 15, 17, and 23 area to north off the map.

Scale 1 inch = 1 mile



Date	Year	Month	Day	Time	Location	Remarks	Notes
Shooting Station	2010	10	10	10:10	10:10	10:10	10:10
Time (AM)	10:10	10:10	10:10	10:10	10:10	10:10	10:10
No. of Hours	10	10	10	10	10	10	10
Sex of Age	6	6	6	6	6	6	6
1st Hour	2	0	0	0	0	0	0
2nd Hour	0	2	2	2	2	2	2
3rd Hour	7	10	10	10	10	10	10
4th Hour	0	0	0	0	0	0	0
5th Hour	1	0	0	0	0	0	0
Totals by Sex	1	2	2	2	2	2	2
Totals	9	9	9	9	9	9	9
Totals per hour	1	1	1	1	1	1	1

Memo: ...  
 1. ...  
 2. ...  
 3. ...



